

Recommended P.C.B Layout(Top Side)
(PCB BOARD TOLERANCE±0.05)

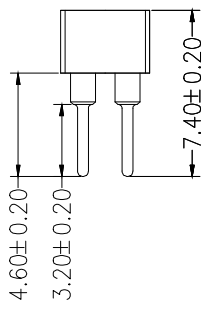
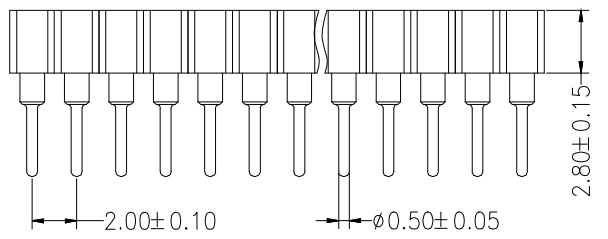
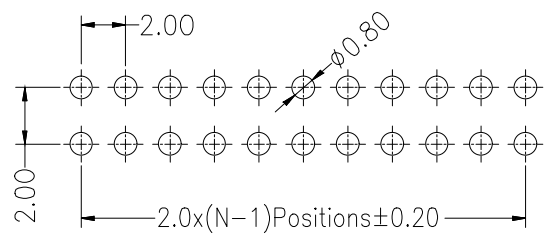

SPECIFICATIONS
Current Rating:3.0AMP
Contact Resistance:10mΩMax
Dielectric Strength:Min 1000V RMS
Operation Temperature:-40°c to +105°c

Contact Material:Brass
Contact Clip(4/6 finger):Becu(C17200)
Accepted Pin:Ø0.40 to 0.60mm
Insulator Material:Polyester(UL94V-0)
Standard: PPS
Soldering temperature: 260°C±5° 5S

Ordering Information

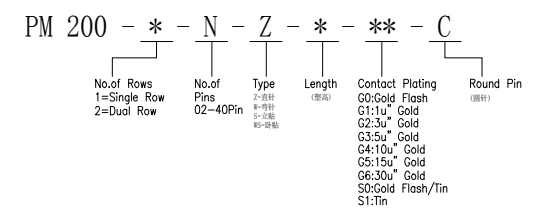

		GENERAL TOLERANCE		制图 DRAWING	深圳市华灿天禄电子有限公司 ShenzhenhuacantianluELECTRONICS CO.,LTD			
		DIM	TOL	审核 CHECK				
		X.X	±0.30	批准 APPROVAL	产品名称 TITLE	2.0 双排 排母 圆直针	版本 REV.	A
		X.XX	±0.20	比例 SCALE	产品料号 PART NO.	PM200-2-N-Z-3.0-XX-C	单位 UNITS	mm
1	初版发行	X.XXX	±0.10	投影 Projection	材料 MATERIAL		页次 SHEET	1/1
序号 No.	变更内容 MODIFY CONTENT	日期 MODIFY DATE	Angle	±3.0°				